



The WHOLE Solution

InnoGain LP

Description:

InnoGain LP Scaffolding plug realizes a recess in which handrail holders for fall protection or edge protection can be placed. The LP Scaffolding plug does not float is quick to install and extremely easy to remove.

The LP Scaffolding plug is pressed into the surface after the concrete is poured and is manufactured for the standard scaffolding bars.

The LP Scaffolding plug saves a lot of plastics compared to traditional systems which has the disadvantage to float quickly due to the light weight and must be kept in the right place during hardening of the concrete with weightings or other fixings. Or it remove the need for drilling on-site.

By producing recesses directly into concrete flooring, InnoGain allows for safer scaffold and post erection on site. The holes can be placed much more accurately than with drilling and offer a much more consistent quality for the depth of the hole.

Specification:

InnoGain LP (Scaffolding plug)

Article	Description	Size (MM)	Weight(KG)
I714150	LP	Ø40x150	0.55
I715150	LP	Ø50x150	0.65

Accessories:

InnoWax

Article	Description	Size	Weight(KG)
I098025	InnoWax	1 ltr	0,90
I098030	InnoWax	5 ltr	4,50



Benefits:

- Durable due to reusability.
- Saving plastic alternatives.
- Suitable for standard scaffolding bars.
- Easy to use.
- Stays in position and does not float up.
- Removal of on-site drilling.
- No dust, risk of vibration exposure.
- No concrete or plastic waste.
- Consistent hole depth and diameter.
- No specialist tools required.
- 100% recyclable.

ARC CONSTRUCTION
SOLUTIONS
IRELAND

Ballykillduff, Tobinstown, Tullow, Co. Carlow.

www.InnoGain.com



InnoGain LP

Installation guide:

- 1** Pour the concrete.
- 2** Press the InnoGain LP Scaffolding plug straight into the poured concrete.
- 3** After the concrete is cured, pull the InnoGain LP Scaffolding plug straight out.
- 4** Result a clean and dust-free hole. The InnoGain LP Scaffolding plug can be used again immediately without any after-treatment.

Once construction is completed the recess is filled with mortar to make good.

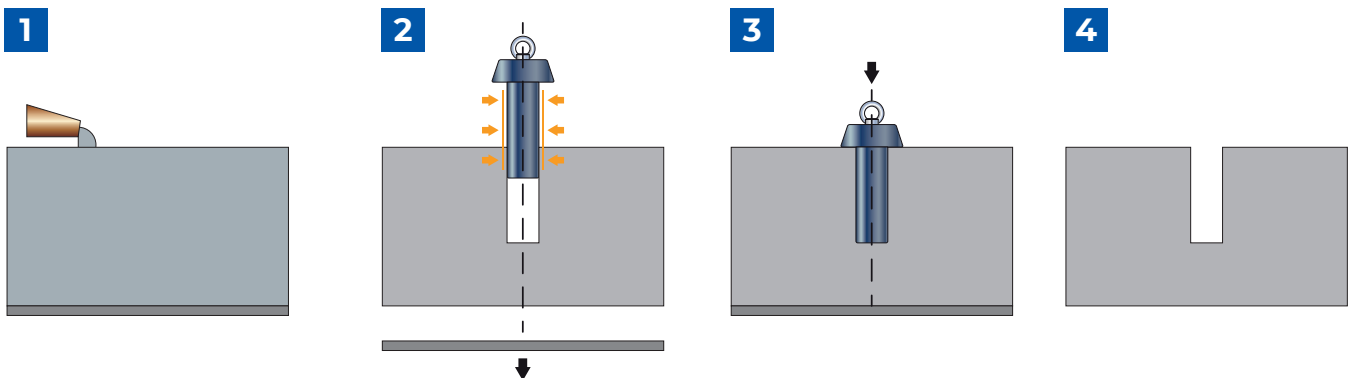

Important remarks:

- a.** Care should be taken to avoid sharp edges which may damage the flexible outer cover.
- b.** InnoGain should only be used in concrete.
- c.** Always ensure the InnoGain is pulled squarely from the concrete.
- d.** After protracted use the InnoGain can get dry noticed by increasing pull resistance - an application of InnoWax can be used to restore the InnoGain.
- e.** Always ensure that the concrete strength and minimum edge distances are sufficient to deliver the strength required in the scaffolding framework. This should be advised by the design engineer.

IMPORTANT: Directions for use are given for guidance only and are not intended to form part of any contract. They should be varied or adapted to suit your particular materials or conditions of use. Goods supplied by the company are made to approved standards from the highest quality raw materials but no warranty or guarantee is given as to their suitability for any particular purpose or application, and no liability is accepted for any loss or damage arising directly or indirectly from the use of the Company's products irrespective of any information given to us as to intended use of such products. It is therefore recommended that prospective users should test a sample of this product under their own conditions to satisfy themselves that the product is suitable for the purpose intended.



Ballykillduff, Tobinstown, Tullow, Co. Carlow.

www.InnoGain.com